

Smart Transfer



Installation Manual

T-MPL

Safety Guidelines

NOTE: This manual is compiled from the latest specifications and product information available at the time of publication. We reserve the right to make changes as they become necessary. Any changes to our products may cause slight variations between the illustrations and explanations in this manual. The latest/current version of this manual is available on our website.

If you require an electronic version or translated version of the manual please scan the QR code or enter the URL (<https://www.mobilityinmotion.com/Autochair-Installer-Manuals>) and select the appropriate manual.

Français - Veuillez scanner le QR Code ou entrer l'URL de la version Française du manuel d'utilisation

Deutsch - Bitte scannen Sie den QR-Code oder geben Sie die URL für die deutsche Version des Benutzerhandbuchs ein

Español - Escanee el código QR o introduzca la URL de la versión en Español del manual del usuario

Italiano - Scansiona il codice QR o inserisci l'URL per la versione Italiana del manuale utente

Polski - Zeskanuj kod QR lub wprowadź adres URL Polskiej wersji instrukcji obsługi

Čeština - Naskenujte prosím QR kód nebo zadejte URL pro Českou verzi uživatelské příručky

Nederlands - Scan de QR-code of voer de URL in voor de Nederlandse versie van de gebruikershandleiding

תירבע - הסרגה רובע רתאה תבוכת תא הן וא ה-QR דוק תא קורס שמתשמל ירדמה לש תירבעה

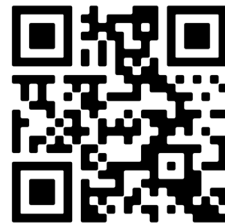

NOTE: This product is compliant with WEEE, RoHS, and REACH directives and requirements.



WARNING! Authorised Autochair technicians & installers are to complete the initial set up of this device. All Installation instructions must be followed.

The following symbols are used to identify warnings and important details throughout this manual. Please read them and ensure you are aware of their meaning.



WARNING! These symbols denote a potentially dangerous situation. Failure to carry out the specified procedures may result in injury or damage to the device.



MANDATORY! The indicated actions must be carried out as specified. Failure to perform the specified actions may result in injury or damage to the device.



PROHIBITED! Do not carry out the indicated actions. They should not be performed at any time, under any circumstances. Carrying out a prohibited action may result in injury or damage to the device.

**UK
CA**

Copyright © 2021
Autochair Ltd.
1214151 Rev. A

Manufactured By:
Autochair Ltd.
Wood Street North
Meadow Lane Industrial
Estate
Alfreton
Derbyshire
DE55 7JR

CE

EU Authorised Representative:
Product IP AR Services
Galvanistraat 1
6716 AE Ede
The Netherlands

Contents

2. TECHNICAL 4

3. INSTALLING 10

4. CILL BRACKET (Optional) 16

5. WIRING 19

2. Technical

FITTING KIT PART ID

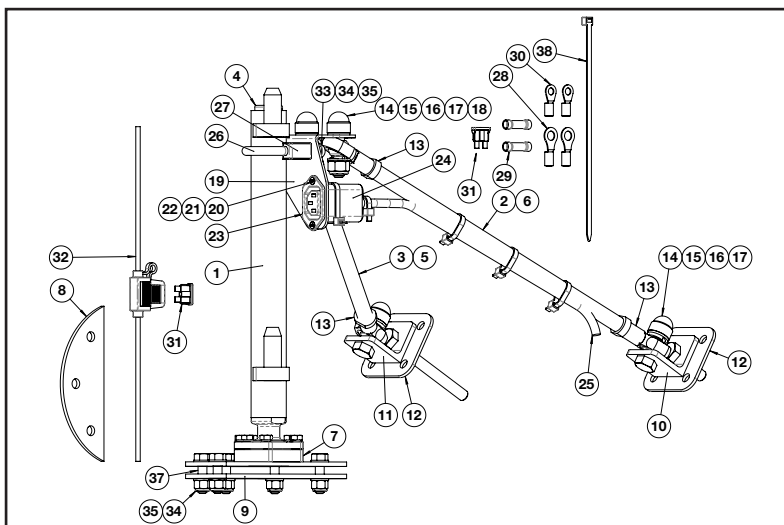

NO.	PART #	ITEM DESCRIPTION	NO.	PART #	ITEM DESCRIPTION
1	C7014072	MPL Mounting Post	20	3432103	M3x12 Countersunk Screw
2	C6014181	Sleeve [700mm]	21	3613106	M3 Flat Washer
3	C6014180	Sleeve [300mm]	22	3523125	M3 Nyloc Nut
4	4020114	Tube Insert	23	5065106	Kettle Plug
5	3911041	M10 Allthread	24	5065104	Rubber Boot
6	3911041	M10 Allthread	25	5068012	Cable
7	8814071	Mounting Post Base	26	C5011103	Exhaust Clamp - 32mm
8	6014060	Small Mounting Plate	27	6014231	Saddle Block
9	6014059	Large Mounting Plate	28	5070085	Large Yellow Ring Connector
10	C7014035	Bulkhead Bracket	29	5070068	Yellow Straight Connector
11	C7014036	Bulkhead Bracket (Long Setscrew)	30	5070064	Small Yellow Ring Connector
12	6010001	5 Hole Clamp Plate	31	5070025	25amp Fuse
13	5058105	M10 Rod End	32	5070004	Splashproof Fuse Holder
14	4010102	M10 Nut Cap	33	4010100	M8 Nut Cap
15	3623107	M10 Spring Washer	34	3613111	M8 Flat Washer
16	3613112	M10 Flat Washer	35	3523104	M8 Nyloc Nut
17	3523105	M10 Nyloc Nut	36	3023211	M8x50 Hex Head Screw
18	3023227	M10x40 Hexagon Head Screw	37	3023207	M8x30 Hex Head Screw
19	C6014145	RH Socket Mounting Plate	38	5071020	Cable Tie

2. Technical

PERSON LIFT PART ID

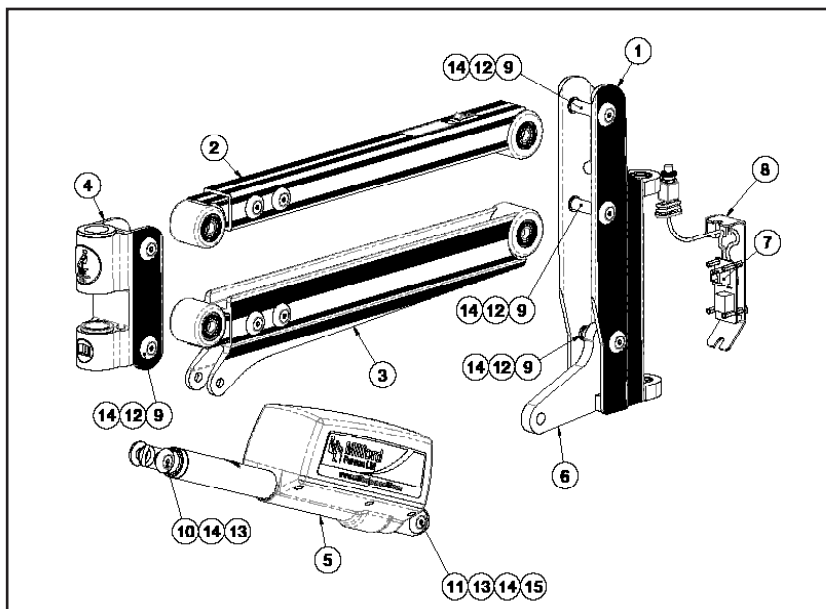

NO.	PART #	ITEM DESCRIPTION
1	C8814102	Rear Post Assembly
2	C8814106	Upper Arm Assembly
3	C8814107	Lower Arm Assembly
4	C8814100	Front Post Assembly
5	9530031	150kg Actuator
6	6014152	150kg Actuator Support Plate
7	5214225	Control Board & Switches
8	6014186	Control Board Cover
9	6014067	Front Post Pin
10	6014153	Spacer (10x46)
11	6014027	Spacer (12x35.8)
12	6014005	Bush - Flanged
13	6014006	Bush
14	3911037	Socket C'Sunk Capscrew M6x16
15	6014154	Actuator Spacer

3. Installing

POST BASE & POST ASSEMBLY

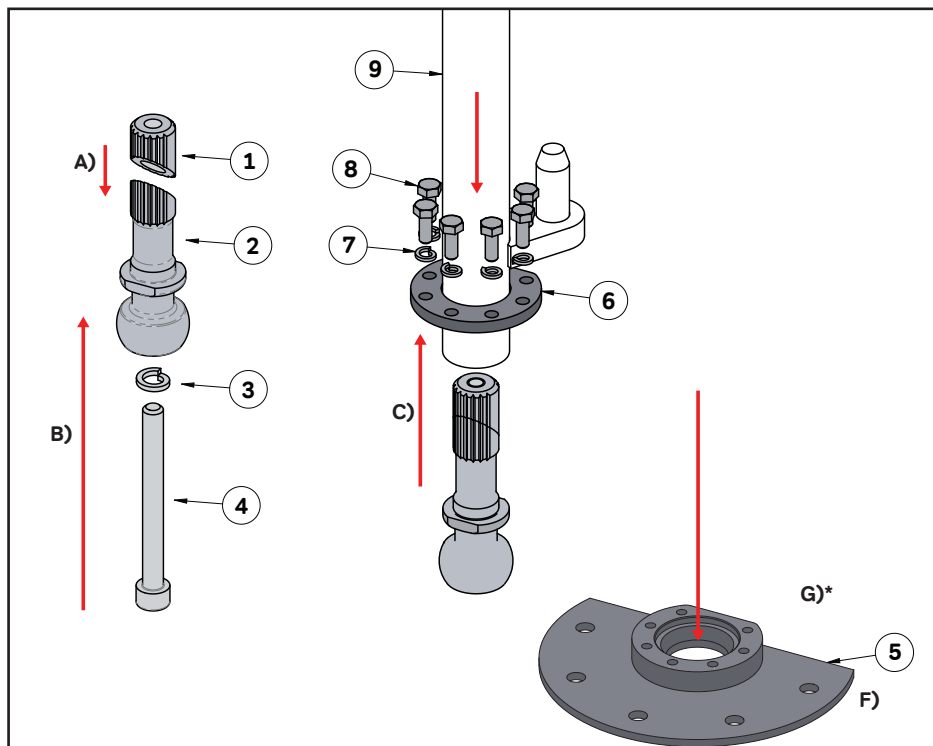

NO.	PART #	ITEM DESCRIPTION
1	6014226	Post Taper Nut
2	6014227	Ball Joint
3	3623107	M10 Spring Washer
4	3413247	M10x100 Cap Screw
5	7014070	Post Base Fabrication
6	6014229	Cap Taper Plate
7	3623105	M6 Spring Washer
8	3023189	M6x16 Hex Head
9	7014072	Mounting Post

A) Place 1 onto 2.

B) Place 3 onto 4 and insert through 2, screwing into 1.

C) Following **Step 5** (next page), locate through 6 and push 9 onto the parts assembled (Ball Joint).

D) Tighten 4 to **60Nm** (See next page).

E) Leave assembled parts to one side.

F) Install Base Plate into the vehicle following instructions on the next page.

G) Insert assembled parts into base plate & tighten 8 through 7 and into baseplate **EVENLY***

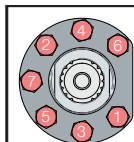

***WARNING** - Ensure that 7 (M6x16 Hex Head Screws) are evenly fastened using the sequence illustrated in the diagram to the left.



3. Installing

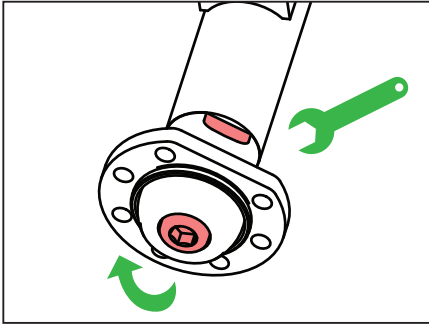

D) CONTINUED Whilst keeping the post secure, use a spanner to hold the flats (highlighted) and tighten **4** securely using appropriate Allen Key. This bolt must be very tight (60Nm), which may cause some bulging of the post.

POST INSTALLATION - BOTTOM MOUNTING



ATTENTION!
If a Cill Bracket is required turn to Section 11 (Page 31)

1. Remove the relevant vehicle trim and carpet in the location that the Post Base will be fitted.

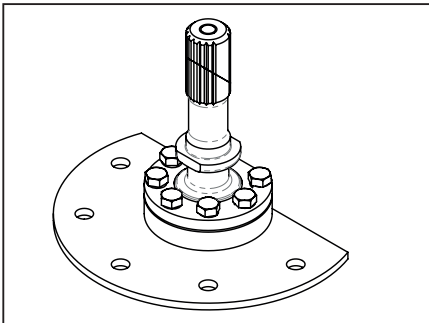

2. **Loosely** assemble the Post Base following the instructions on the previous page (**A, B, G**).

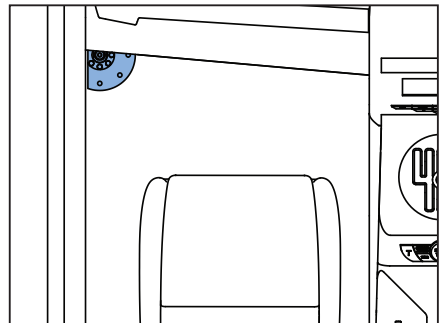

3. Position the Post Base assembly as close to the door sill and the dashboard as possible.

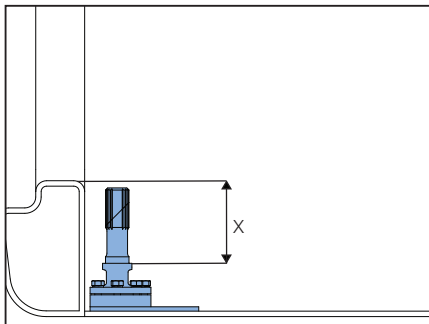

4. Measure "X" from the top of the Post Base to the top of the Sill.

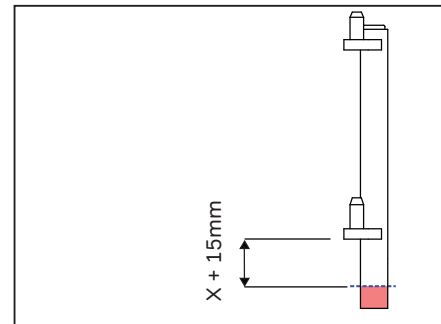

5. Measure "X" down from the lower mounting pin plate, add 15mm allowance for any trim that has been removed from the sill. Mark and cut the Post at this distance.

3. Installing

6. Disassemble the Post Base parts and assemble to steps **A-G on Page 26**. Do not fully tighten **8** (M6 Setscrews).

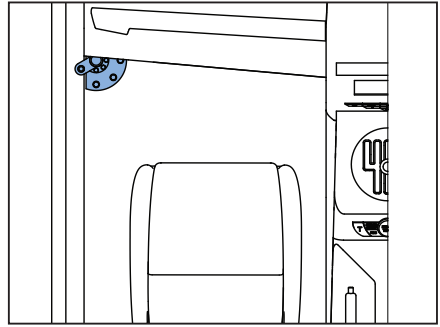
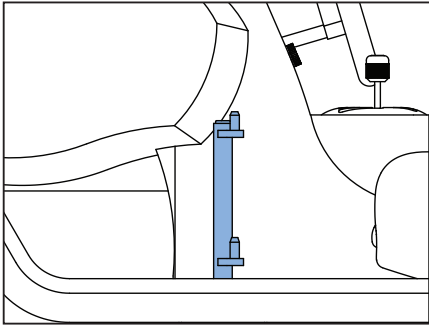

7. Position the Mounting Post and Post Base as near to the vehicle dashboard as possible ensuring that clearance is allowed for the Person Lift to be hooked on & off. Also check the Person Lift clears the corner of the vehicle dash as it rotates on its fixings and that the post will not contact the door when closed.



WARNING! Check that the Post Base is on as flat a surface as possible. Before drilling any mounting holes check for brake and fuel lines, wiring harnesses etc.

8. Remove the Mounting Post from the Post Base Assembly.

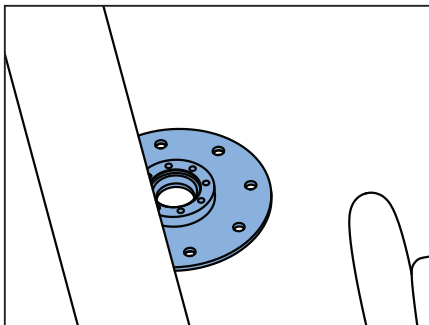

9. Find suitable points for securing the Post Base to the vehicle floor. Check the Post is vertical then mark the four points.

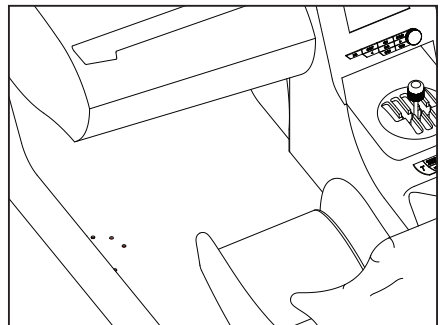

10. Remove the Post Base and drill the vehicle floor through 9mm for M8 Setscrews.

3. Installing

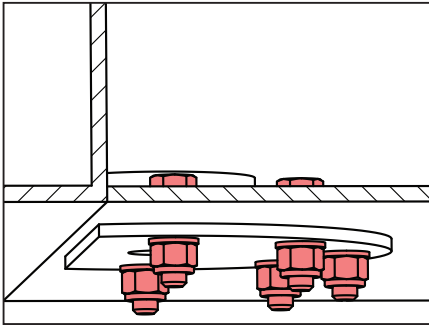

11. Fix the Post and Base into the pre-determined position using M8 x 30 Hexagon Setscrews and Nyloc Nuts with washers. Ensure that the flat mounting plate is secured beneath the vehicle floor using sealer to prevent the ingress of water.

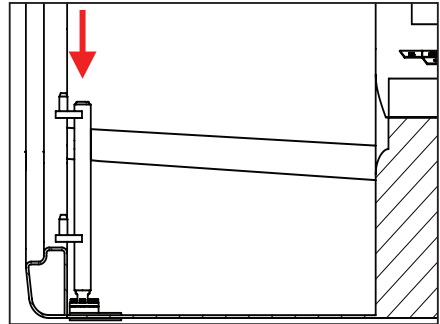

12. With the Post and Ball Joint already assembled (**See Page 26, Steps A-D**), set the angle and tighten the Cap Plate **6** down **EVENLY*** using **7** and **8** to 10Nm.

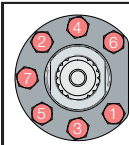

***WARNING** - Ensure that **7** (M6x16 Hex Head Screws) are evenly fastened using the sequence illustrated in the diagram to the left.

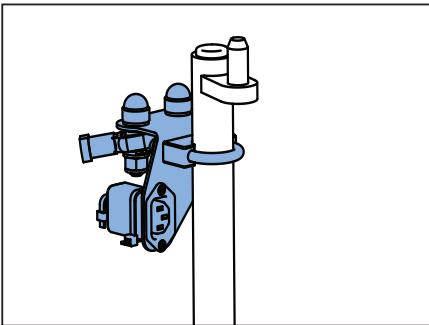

13. Loosely assemble the top mounting in the ideal position.

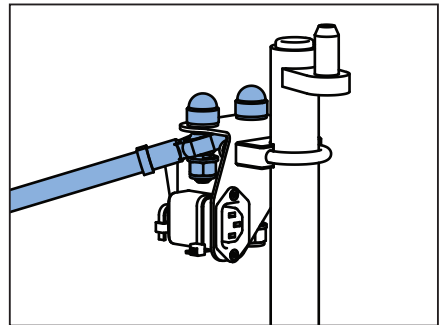

14. Trial the short Brace Bars in the Rose Joints and check that the bars will not foul the dash board. Locate and mark two suitable positions for the Transition Brackets to mount checking there are no obstructions on the other side of the panels such as wiring, brake or fuel lines etc.

3. Installing

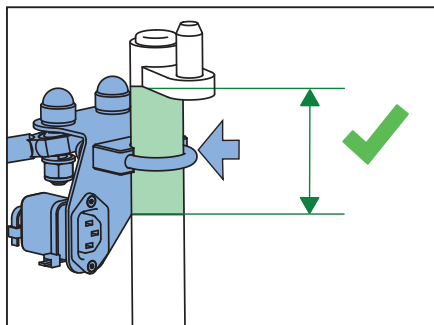

15. The brace bars should be spread as wide as possible. Suitable locations for the transition brackets are the vehicle bulkhead, transmission tunnel and wheel arch. The higher up the post and the further apart they are, the more stable the post installation will be.

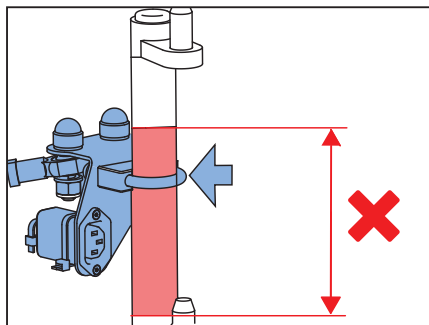

15. CONTINUED - When fitting the Brace Bar U Clamp ensure it is as high up the mounting post as possible.

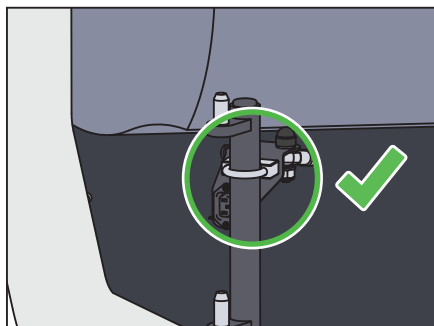

3. Installing

POST INSTALLATION - TOP MOUNTING

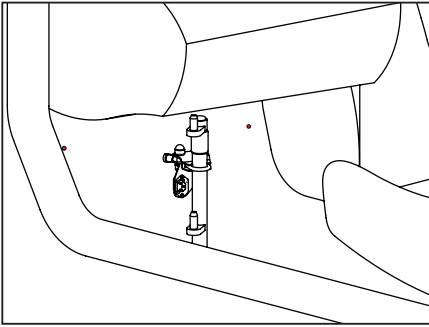

16. Drill two holes Ø10.2mm

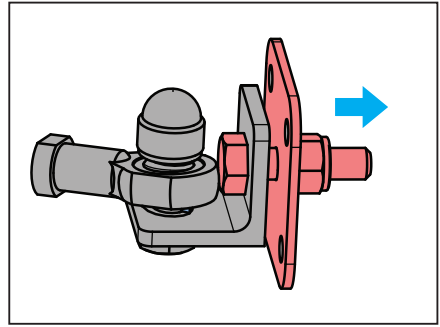

17. Remove the five hole plate and Nyloc Nut from the Transition Bracket.

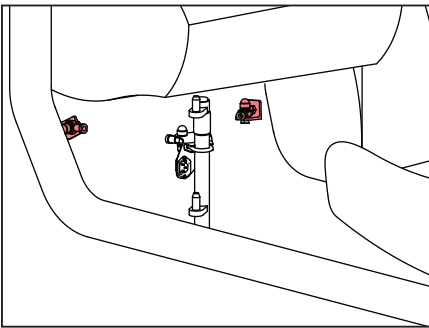

18. Fit the Brackets through the bulkhead.

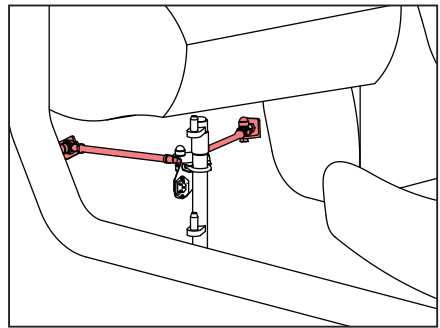

19. Carefully measure and cut the threaded rod and sleeve. Then fit them between the rod ends. Once all parts are installed correctly, fully tighten all the fixings.

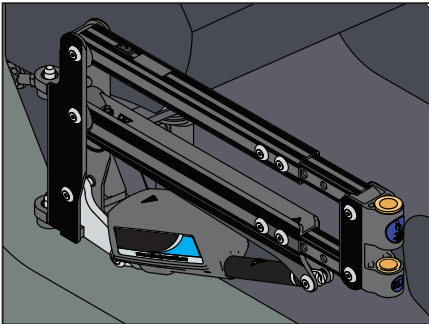

20. Route the wiring, fit all the plastic nut caps and refit all the trim and carpet.

21. The Person Lift should be fitted to the Post and the stability tested before using to lift a person. Once some weight has been applied to the installation check all the fixings are tight.

22. Removal of the Fitting Kit is the reverse of the installation.

4. Cill Bracket - OPTIONAL

Cill Bracket INSTALLATION

When installing a Person Lift; it may be necessary to use a Cill Bracket in order to clear large or unusually shaped door Cills or to fit around an extended or protruding dashboard. The following instructions should be used to ensure the Cill Bracket is correctly and safely installed in the vehicle. **The Cill Bracket is OPTIONAL and isn't part of every install.**

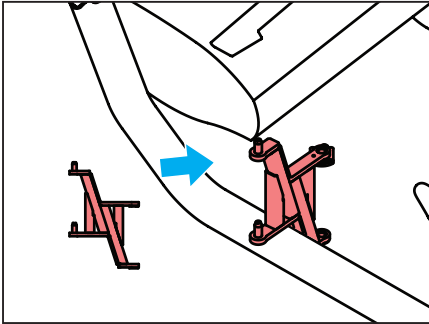

22. Offer Cill Bracket into vehicle in its approximate intended position

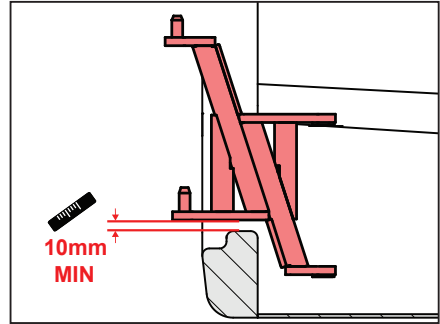

23. Ensure a minimum 10mm gap as shown (TIP: Use a suitably sized packer to support Bracket)

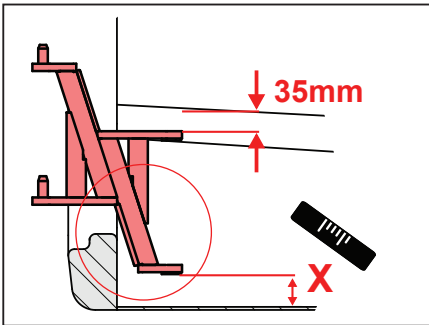

24. Ensure there is a minimum clearance of 35mm between Bracket and dash (for Bracket removal after Post installation) as shown.

Whilst maintaining 10mm from the Cill as shown in Step 23 carefully measure X (the gap between floor and lower section of Bracket).

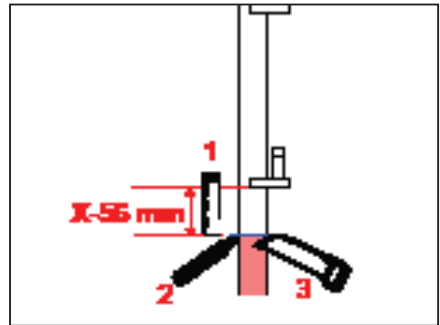

25. Measure and mark the Post as shown.

4. Cill Bracket - OPTIONAL

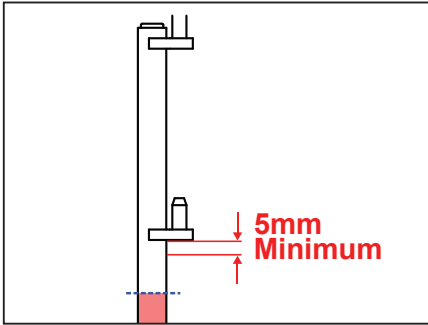

25. CONTINUED - Do NOT remove more than the 5mm Minimum. If X- 56 = less than 5mm then 5mm must be used.

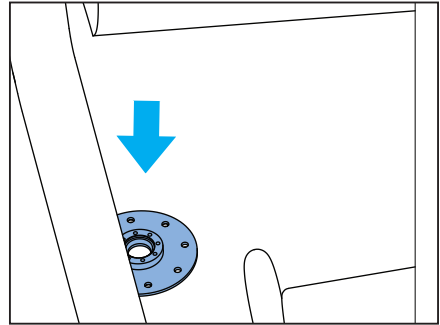

26. Place the Post Base Assembly onto the car floor.

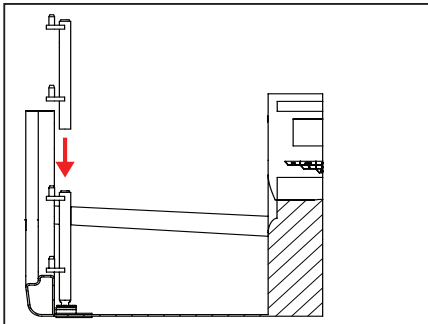

27. With the Post and Ball Joint already assembled (**See Page 26, Steps A-D**), set the angle and tighten the Cap Plate **6** down **EVENLY*** using **7** and **8** to 10Nm.

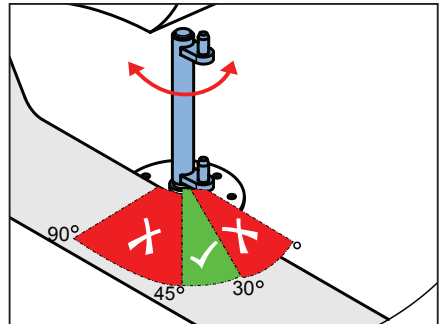

28. Rotate the Post to within the angle range as shown and tighten the Cap Plate **6** down **EVENLY*** using **7** and **8** to 10Nm.

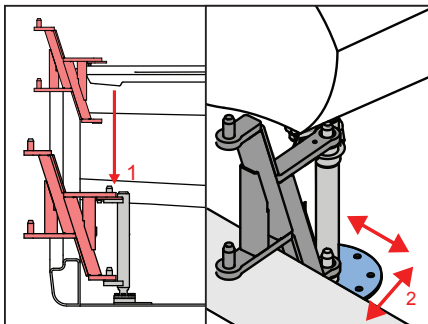

29. Place the Bracket on the Post (1) and locate the Assembly into the desired position (2).

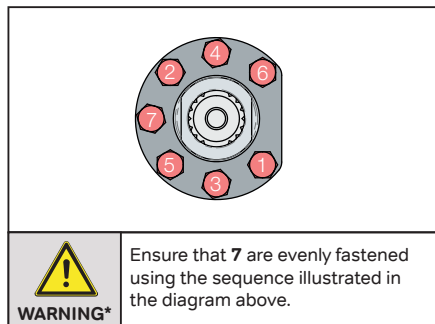

4. Sill Bracket - OPTIONAL

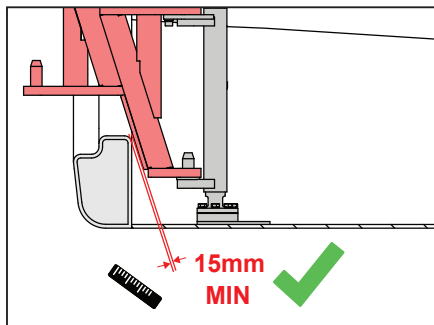

31. Ensure there is a 15mm gap between sill and bracket. Ensure the bracket has adequate clearance for removal from post.

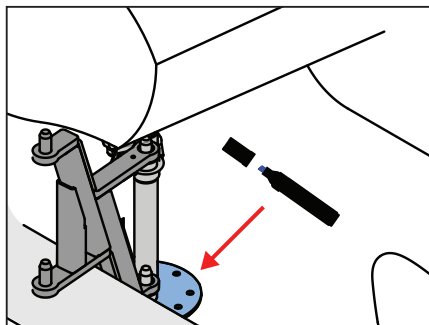

32. Mark holes on the floor for drilling.

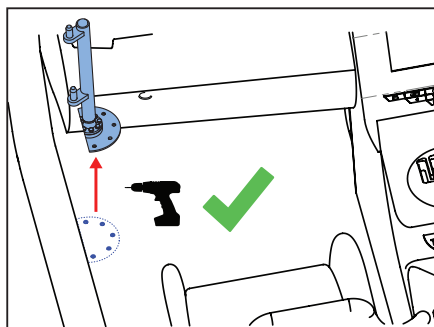

33. Remove bracket, post and base plate assembly. Return to instruction 9 and proceed to complete base and post fitting.

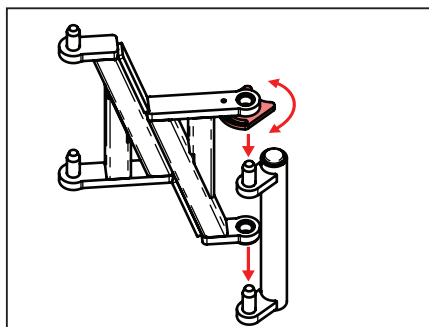

34. Place the bracket on the post. Rotate bracket to required angle.

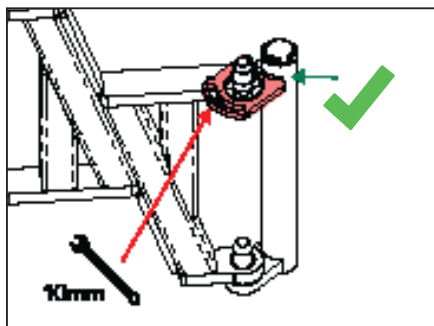

35. Tighten the bolt to set the bracket in the required angle.

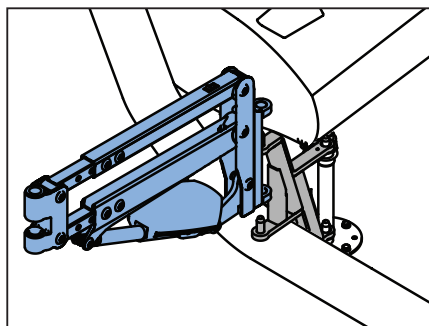

36. The bracket is now ready to mount the Person Lift. Reset bracket angle if required.

5. Wiring

WIRING AND ELECTRICS

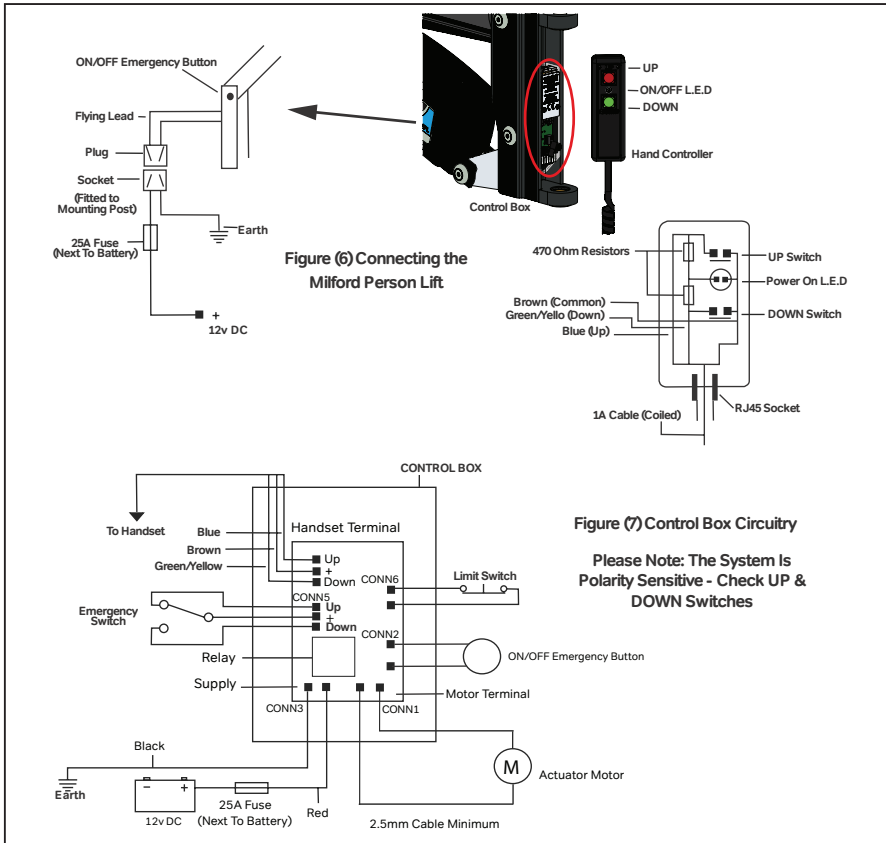

- The wiring supplied for connecting the battery and power socket is twin core with red & black insulation.
- The power connection socket is best positioned on the outside of the post (toward the door).
- Run the cable down the brace bar and through the bulkhead (use the grommet supplied if required) to the vehicle battery. Secure the cable where required using the cable ties provided.
- Connect both wires to the battery. Use the inline fuse holder provided on the positive connection. Wire as follows black = negative / red = positive. A spare 25 AMP fuse is provided and should be handed to the customer or located in an obvious and appropriate position.
- DO NOT use a painted surface to achieve an earth. This could lead to intermittent operation of the Person lift.
- Place the Person Lift onto the mounting post lugs, connect plug, affix extension bar and spreader bar, test by loading up to 23 and a half stone (150kg) maximum (refer to page 21 of the Owners Manual for the correct weight for your specific installation) and make sure excessive deflection of all fixings is not present.
- Check all nuts/bolts for security & waxoyl all exposed fixings to prevent corrosion.

